

ASSEMBLY INSTRUCTIONS

LEXINGTON QUEEN BED

THANK YOU FOR PURCHASING THIS QUALITY PRODUCT. READ THIS INSTRUCTION CAREFULLY.
SEE PART LIST AND HARDWARE LIST FOR GUIDANCE, BE SURE ALL PARTS ARE COMPLETE BEFORE YOU ASSEMBLE.

- CAUTIONS:
- 1. DO NOT FULLY TIGHTEN THE BOLTS UNTIL ALL BOLTS IS READY ASSEMBLED.
 - 2. DO NOT OVER TIGHTEN THE BOLTS TO AVOID CAUSING DAMAGES TO THE THREAD.
 - 3. KEEP ALL PART AND HARDWARE OUT TO REACH BY CHILDREN.

TOOLS NEEDED : SCREWDRIVER (NOT PROVIDED)

PART LIST		
ITEM	DESCRIPTION	QTY
A	HEADBOARD	1 PC
B	FOOTBOARD	1 PC
C	SIDERAIL	2 PCS
D	CENTER SUPPORT	1 PC
E	CENTER SUPPORT LEG	3 PCS
F	SLATS	1 SET
G	BED LEG	4 PCS

HARDWARE LIST		
ITEM	DESCRIPTION	QTY
1	CSK SCREW M4 x 20mm 	2 PCS
2	CSK SCREW M4 x 38mm 	9 PCS
3	ALLEN KEY M5 	1 PC

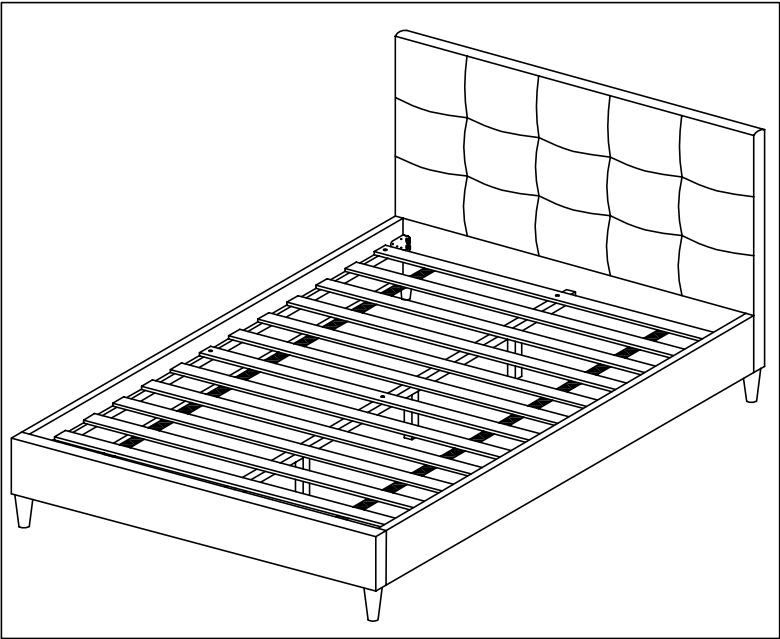

STEP 1

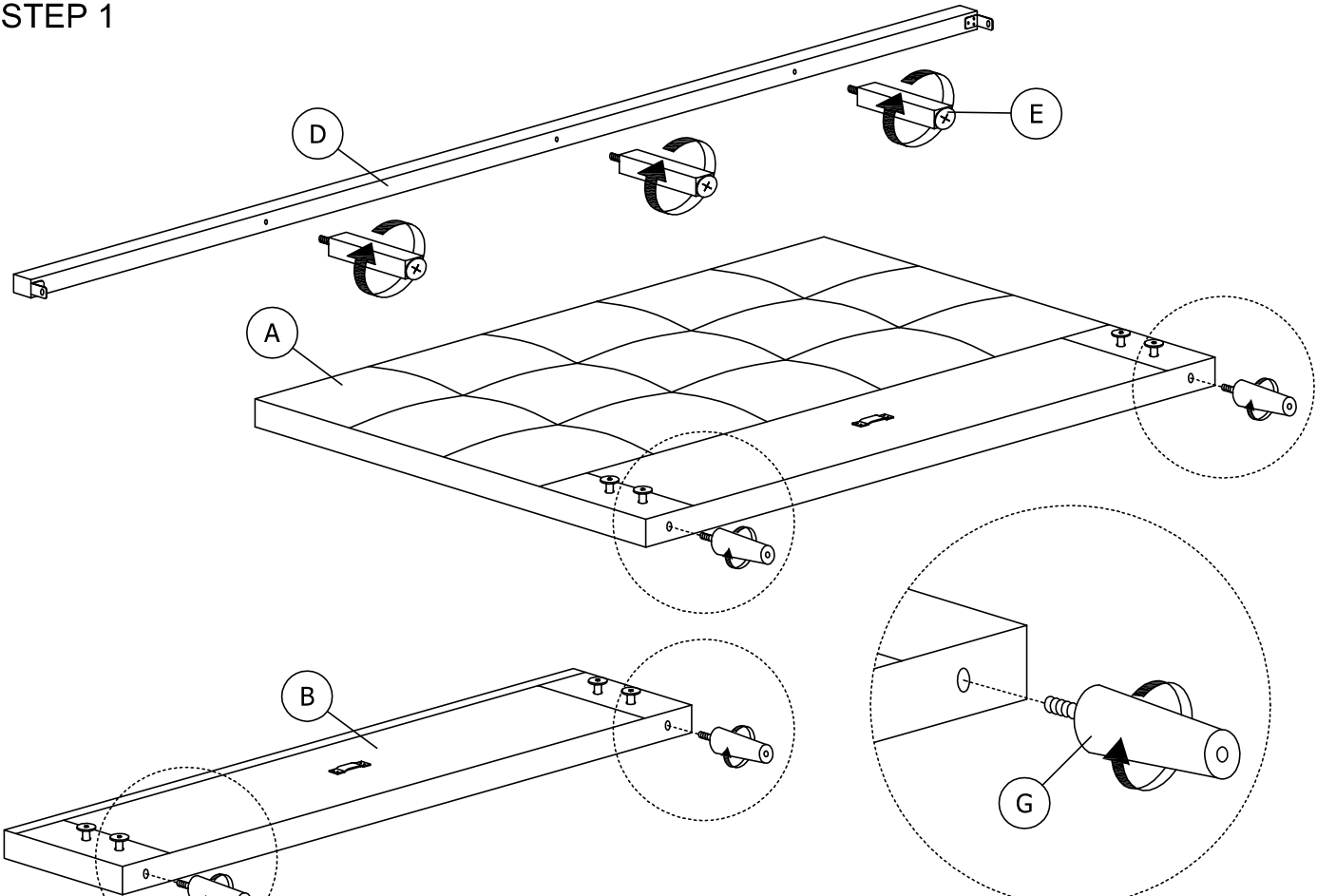

STEP 2

STEP A : Use the ALLEN KEY M5 (3) to turn loose all the JCBB BOLT prefix at HEADBOARD (A) & FOOTBOARD (B) and don't pull out. Hang the SIDE RAILS (C) to HEADBOARD (A) & FOOTBOARD (B).
 STEP B : Tighten them after assembly the SIDE RAILS (C).

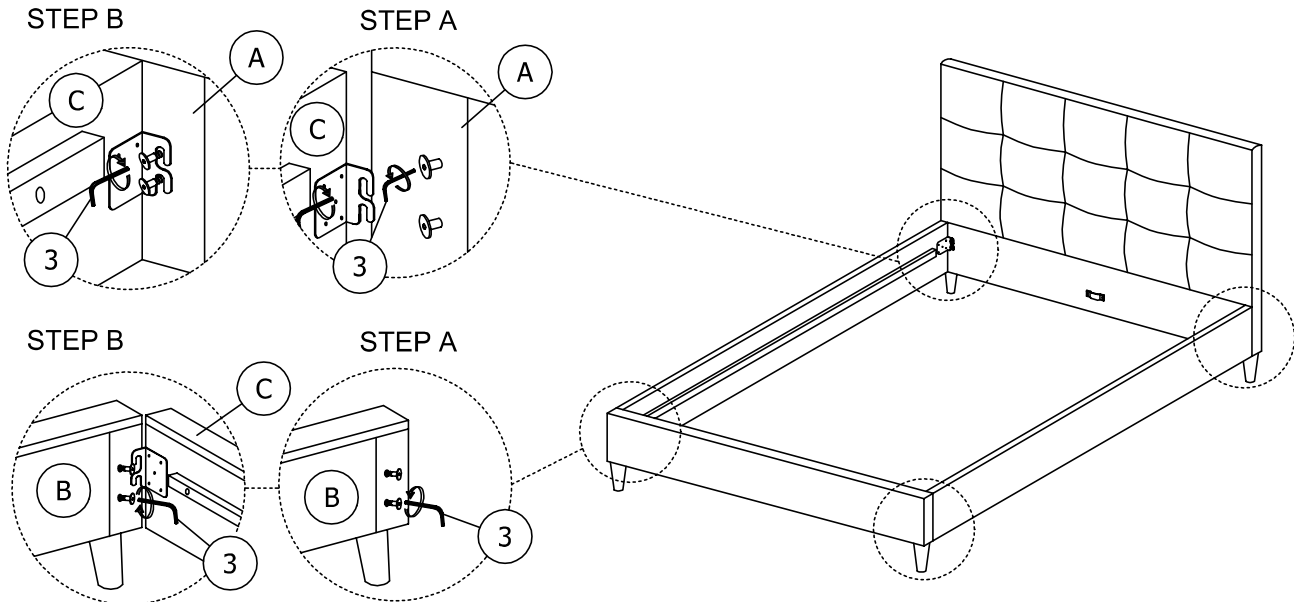

STEP 3

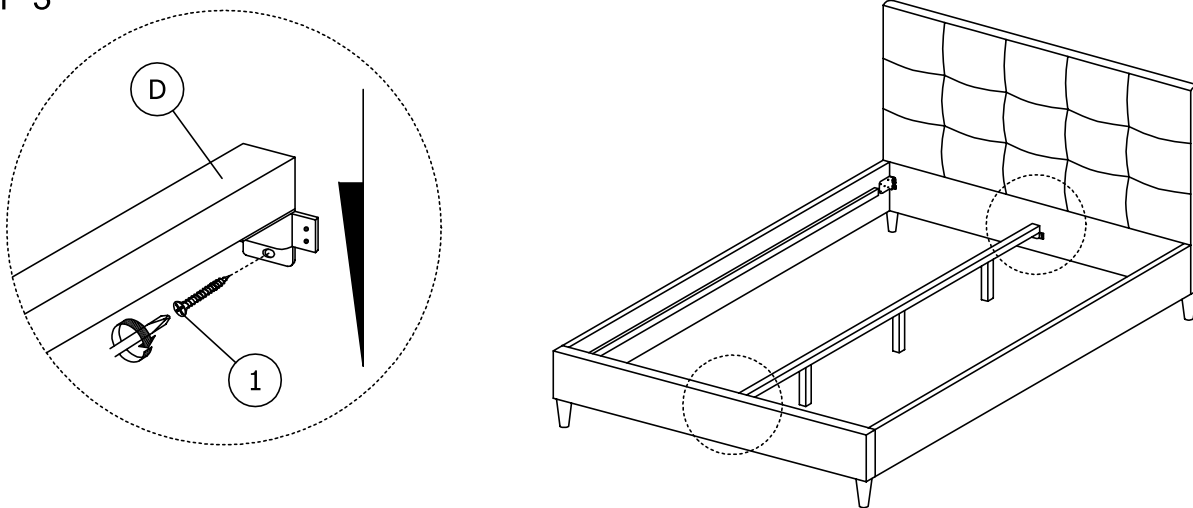

STEP 4

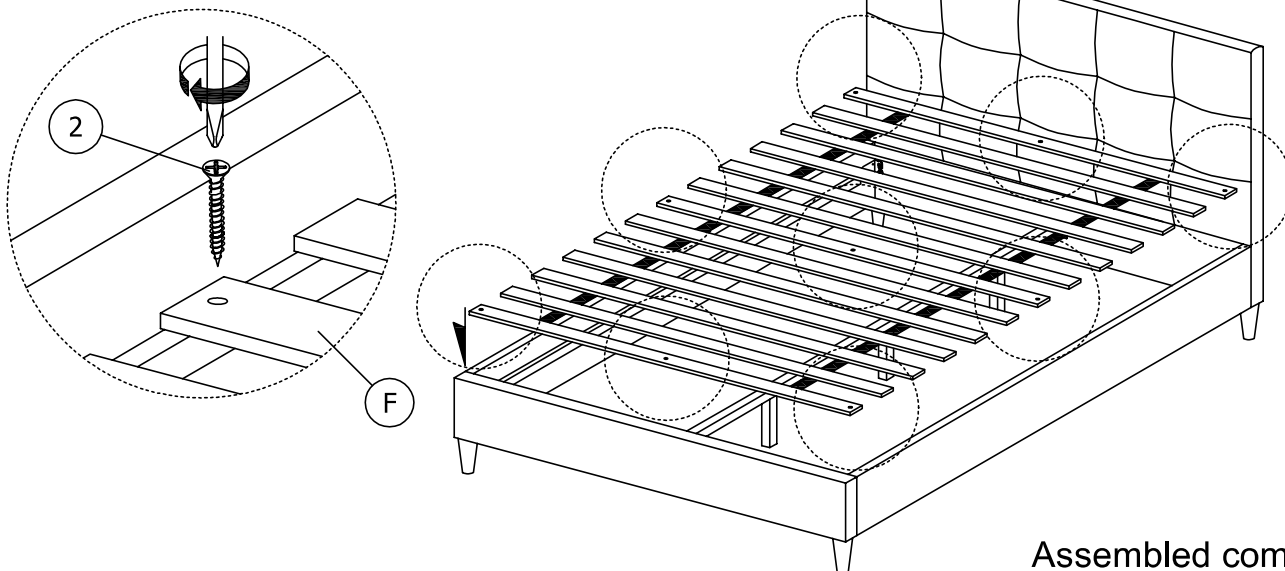

Assembled completed